

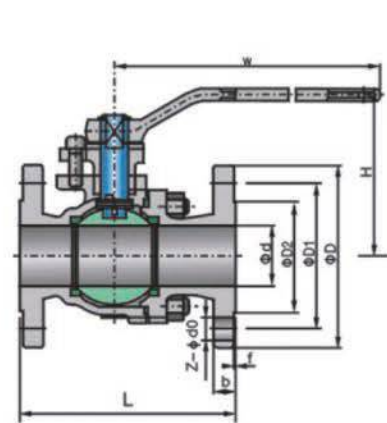

Q41F/H/Y浮动球阀  
Q41F/H/Y Floating Ball Valve

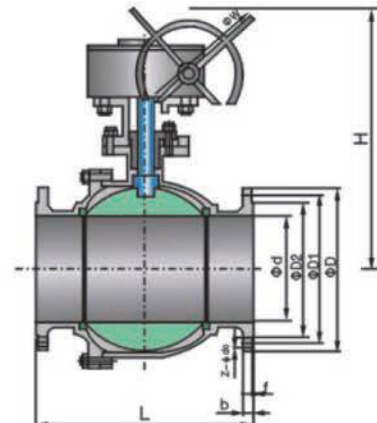

手动操作  
Lever-Operated



蜗轮传动操作  
Worm Gear Operated

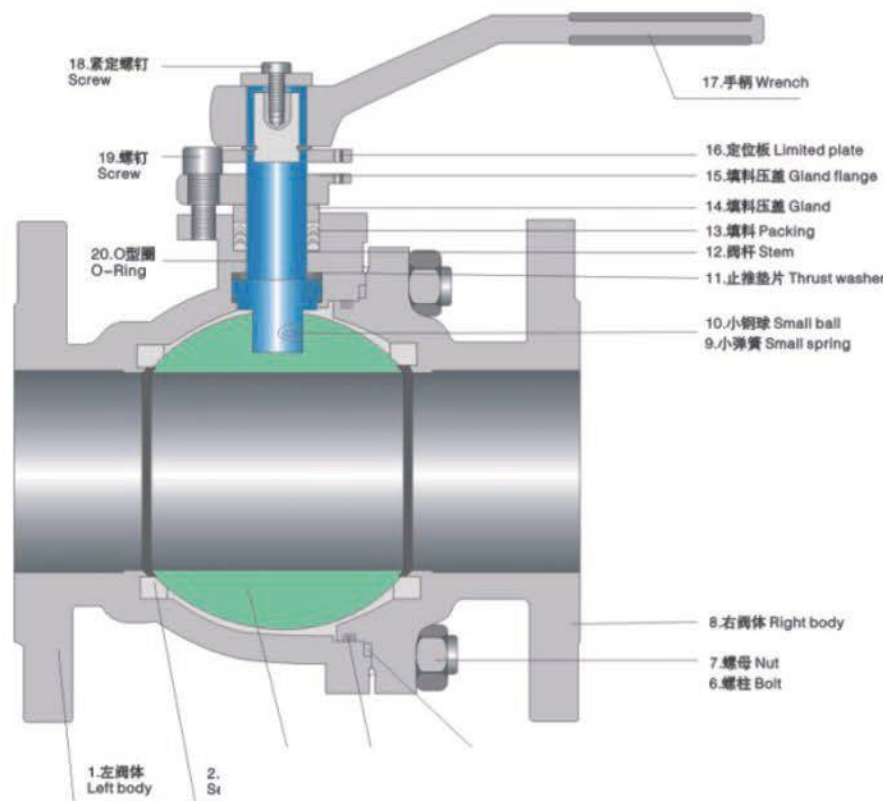

主要外形和连接尺寸 Main shape and connection dimension

型号	公称通径 DN(mm)	尺寸(mm)							
		L	D	D1	D2	b-f	Z-φd	H	Do
Q41 <sup>H</sup> <sub>F</sub> -16 <sup>C</sup> <sub>R</sub>	15	130	95	65	45	14-2	4-14	60	108
	20	140	105	75	55	14-2	4-14	64	120
	25	150	115	85	65	16-2	4-14	90	165
	32	165	135	100	78	18-2	4-18	105	180
	40	180	145	110	85	16-3	4-18	150	240
	50	200	160	125	100	16-3	4-18	190	240
	65	220	180	145	120	18-3	4-18	195	320
	80	250	195	160	135	20-3	8-18	215	350
	100	280	215	180	155	20-3	8-18	250	400
	125	320	245	210	185	22-3	8-18	280	500
	150	360	280	240	210	24-3	8-23	320	600
	200	400	335	295	265	26-3	12-23	370	800
Q41 <sup>H</sup> <sub>F</sub> -25 <sup>C</sup> <sub>R</sub>	15	130	95	65	45	14-2	4-14	60	108
	20	140	105	75	55	14-2	4-14	64	120
	25	150	115	85	65	16-2	4-14	90	165
	32	165	135	100	78	18-2	4-18	105	180
	40	180	145	110	85	16-3	4-18	160	240
	50	200	160	125	100	20-3	4-18	205	270
	65	220	180	145	120	22-3	8-18	215	350
	80	250	195	160	135	22-3	8-18	230	400
	100	280	230	190	160	24-3	8-23	270	500
	125	320	270	220	188	28-3	8-25	300	600
	150	360	300	250	218	30-3	8-25	340	900
	200	400	360	310	278	34-3	12-25	400	1100
Q41 <sup>H</sup> <sub>F</sub> -40 <sup>C</sup> <sub>R</sub>	15	130	95	65	45	16-2	4-14	40	60
	20	140	105	75	55	16-2	4-14	51	65
	25	150	115	85	65	18-2	4-14	58	90
	32	180	135	100	78	18-3	4-18	66	105
	40	200	145	110	85	20-3	4-18	76	170
	50	220	160	125	100	20-3	4-18	88	230
	65	250	180	145	120	22-3	8-18	110	250
	80	280	195	160	135	22-3	8-18	121	250
	100	320	230	190	160	24-3	8-23	150	295
	125	400	270	220	188	28-3	8-25	176	330
	150	400	300	250	218	30-3	8-25	204	375
	200	502	375	320	282	38-3	12-30	260	440
Q41 <sup>H</sup> <sub>F</sub> -64 <sup>C</sup> <sub>R</sub>	15	140	105	75	55	18-2	4-14	60	40
	20	160	125	90	68	20-2	4-18	65	51
	25	180	135	100	78	22-2	4-18	90	58
	32	200	150	110	82	24-2	4-23	105	66
	40	220	165	125	95	24-3	4-23	170	76
	50	250	175	135	105	26-3	4-23	230	88
	65	280	200	160	130	28-3	8-23	250	110
	80	320	210	170	140	30-3	8-23	295	121
	100	360	250	200	168	32-3	8-25	330	150
	125	400	295	240	202	36-3	8-30	475	178
	150	500	340	280	240	38-3	8-34	650	204
	200	600	405	345	300	44-3	12-34	990	280





Q47F/H/Y固定球阀  
Q47F/H/Y Trunnion Mounted Ball Valve

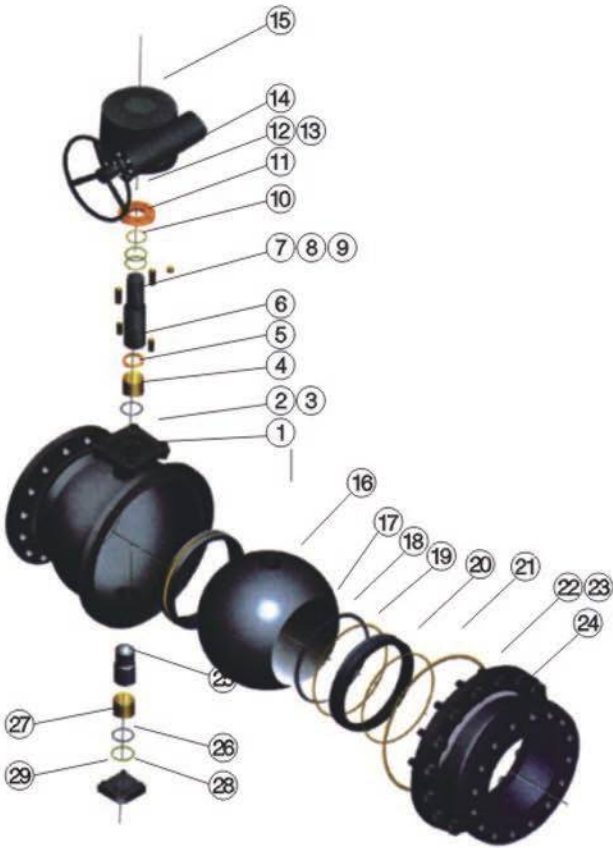
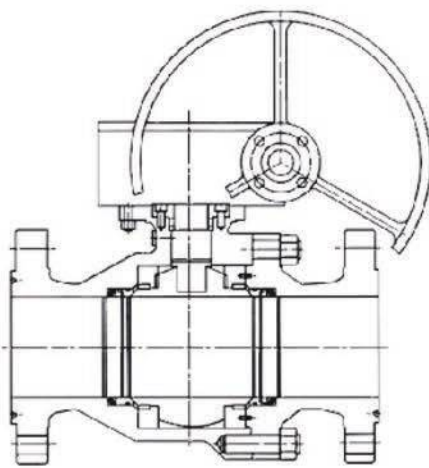

- 1、阀杆孔 Stem Hole
- 2、螺柱 Stud
- 3、螺母 Nut
- 4、O型圈 O-Ring
- 5、轴套 Shaft Sleeve
- 6、隔圈 Spacer
- 7、阀杆 Stem
- 8、键 Key
- 9、键 Key
- 10、O型圈 O-Ring
- 11、垫片 Gasket
- 12、压盖 Gland
- 13、螺钉 Screw
- 14、O型圈 O-Ring
- 15、蜗轮蜗杆  
传动装置  
Worm Gear Operated

- 16、球体 Ball
- 17、O型圈 O-Ring
- 18、阀座 Seat
- 19、弹簧 Spring
- 20、垫片 Gasket
- 21、螺柱 Stud
- 22、螺母 Nut
- 23、阀盖 Bonnet
- 24、下轴 Lower Shaft
- 25、O型圈 O-Ring
- 26、调整垫 Spacer Shim
- 27、下端盖 Lower Cover
- 28、螺钉 Screw

主要外形和连接尺寸 Main shape and connection dimension

型号	公称通径 DN(mm)	尺寸(mm)							
		L	D	D1	D2	b	f	Z-Φd	H(347型)
Q347F <sup>H</sup> <sub>F</sub> -1.6 <sup>C</sup> <sub>R</sub>	50	220	160	125	100	16	3	4-18	
	65	241	180	145	120	18	3	4-18	
	80	283	195	160	135	20	3	8-18	
	100	305	215	180	155	22	3	8-18	
	125	356	245	210	185	22	3	8-18	
	150	394	280	240	210	24	3	8-23	305
	200	457	335	295	265	26	3	12-23	398
	250	533	405	355	320	30	3	12-25	495
	300	610	460	410	345	30	4	12-25	580
	350	686	520	470	485	34	4	16-25	625
	400	762	580	525	485	36	4	16-30	720
	450	864	640	585	545	40	4	20-30	770
	500	914	705	650	608	44	4	20-34	840
	600	1067	840	770	718	48	4	20-41	920
Q347F <sup>H</sup> <sub>F</sub> -2.5 <sup>C</sup> <sub>R</sub>	700	1245	910	840	788	50	5	24-41	990
	50	220	160	125	100	20	3	4-18	
	65	241	180	145	120	22	3	8-18	
	80	283	195	160	135	22	3	8-18	
	100	305	230	190	160	24	3	8-23	
	125	381	270	220	188	28	3	8-25	
	150	403	300	250	218	30	3	8-25	305
	200	502	360	310	278	34	3	12-25	398
	250	568	425	370	332	36	3	12-30	495
	300	648	485	430	390	40	4	16-30	580
	350	762	550	490	448	44	4	16-34	625
	400	838	610	550	505	48	4	16-34	720
	450	914	660	600	555	50	4	20-34	770
	500	991	730	660	610	52	4	20-41	840
Q347F <sup>H</sup> <sub>F</sub> -4.0 <sup>C</sup> <sub>R</sub>	600	1067	840	770	718	56	5	20-41	920
	700	1245	955	875	815	60	5	24-48	990
	50	220	160	125	100	20	3	4-18	
	65	241	180	145	120	22	3	8-18	
	80	283	195	160	135	22	3	8-18	
	100	305	230	190	160	24	3	8-23	
	125	381	270	220	188	28	3	8-25	
	150	403	300	250	218	30	3	8-25	305
	200	502	375	320	282	38	3	12-30	398
	250	568	445	385	345	42	3	12-34	495
	300	648	510	450	408	46	4	16-34	580
	350	762	570	510	465	52	4	16-34	625
	400	838	655	585	535	58	4	16-41	720
	450	914	680	610	560	60	4	20-41	770
Q347F <sup>H</sup> <sub>F</sub> -6.4 <sup>C</sup> <sub>R</sub>	500	991	755	670	612	62	4	20-48	840
	600	1143	890	795	730	62	5	20-54	920
	700	1346	995	900	835	68	5	24-54	990
	50	292	175	135	105	26	3	4-23	
	65	330	200	160	130	28	3	8-23	
	80	356	210	170	140	30	3	8-23	
	100	432	250	200	168	32	3	8-25	
	125	508	295	240	202	36	3	8-30	340
	150	559	340	280	240	38	3	8-34	435
	200	660	405	345	300	44	3	12-34	
	250	787	470	400	352	48	3	12-41	
	300	838	530	460	412	54	4	16-41	
	350	889	595	525	475	60	4	16-41	
	400	991	670	585	525	66	4	16-48	
	450	1092	670	630	570	70	5	20-48	
	500	1194	800	705	640	70	5	20-54	
	600	1397	930	820	750	76	5	20-58	



Q-(3)41、(3)47、(3)61、(3)67F/Y

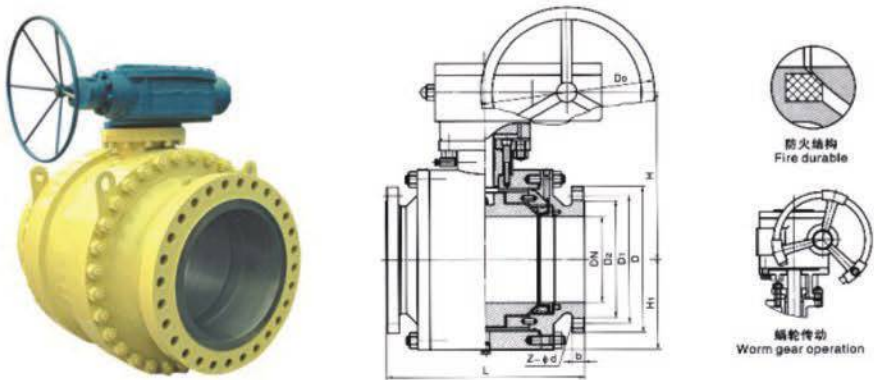

产品执行标准 Product performance standards

产品规范 Product Specification	设计规范 Design Spec.	结构长度 Face to Face	连接法兰 Flange End	试验与检验 Test&Check	产品标识 Marking	供货规范 Supply
	API608 API6D	ANSI B16.10 API 6D	ANSI B116.5	API15989 API6D	MSS SP-25 API 6D	API608 API 6D

产品性能规范 Product performance specification

公称压力(Lb)Nominal Pressore	150Lb	300Lb	400Lb	600Lb
壳体试验压力 Shell test pressure	3.1	7.5	10.2	15.0
密封试验(液) Seal test	2.2	5.5	7.48	11.0
密封试验(气) Seal test	0.5~0.7			
适用介质 Suitbale medium	C 水、油品、蒸汽 Water,oil,steam P 硝酸类 Nitric acid R 醋酸类 Acetic acid			
适用温度 Applicable temperature	≤200℃			

主要零件材料 Main material

名称 Parts name	WCB	CF8	CF3	CF8M	CF3M
阀体左体 Body&Body cap	A216-WCB	A315-CF8	A35-CF3	A351-CF8M	A351-CF3M
球体 Ball	B2-B8	A182-F304L	A182-F304L	A132-F316	A182-F316L
	B8以上	A351-CF8M	A351-CF3	A351-CF8M	A351-CF3M
阀杆 StemI	A182-F6a	A182-F304	A182-F304L	A182-F336	A182-F316L
阀座 Seat	PTFE/增强PTFE、NYLIN PTFE、Reinforced PTFE/Nylon				
阀座支承圈 Seat Retainer	A105-125	A182-F304	A182-F304L	A182-F316	A182-316L
弹簧 Spring	3yc-7/71-49H				
O形圈 O-ring	NBR	氟橡胶 Viton			
螺栓 Stud	A193-B7	A193-B8			
螺母 Nut	A194-2H	A194-8			

主要外形和连接尺寸 Main shape and connection dimension

CLASS 400 A4B(3)41、(3)47、(3)67F/Y(N.PPL).(P.RV)

NPS In	主要外形尺寸和连接尺寸 (mm) Main external and connecting dimensions												WT (Kg)	备注 Remark
	d	L-RF	L-BW	D	D1	D2	b	f	N-φ	H1	H2	D0		
1/2'	13	108	-	89	60.5	35	11.2	1.6	4-16	-	59	130	2.3	浮动球 Float Ball
3/4'	19	117	-	98	70	43	11.2	1.6	4-16	-	63	130	3.0	
1'	25	127	-	108	79.5	51	11.2	1.6	4-16	-	75	160	4.5	
1 1/2'	38	165	190	127	98.5	73	14.3	1.6	4-16	-	95	230	7.0	
2'	51	178	216	152	120.5	92	15.9	1.6	4-19	-	107	230	9.5	固定球 Fixing Ball 浮动球 Float Ball
2 1/2'	61	190	241	178	139.5	105	17.5	1.6	4-19	-	142	400	15.0	
3'	76	203	283	190	152.5	127	19.1	1.6	4-19	-	152	400	19.0	
4'	102	229	305	229	190.5	157	23.9	1.6	8-19	-	178	700	33.0	
5'	127	356	-	254	216	186	23.9	1.6	8-22	-	252	1100	58.0	
6'	52	394	457	279	241.5	216	54.5	1.6	8-22	-	272	1100	93.0	
8'	203	457	521	343	298.5	270	58.6	1.6	8-22	-	342	1500	160.0	
8'	203	457	521	343	298.5	270	28.6	1.6	8-22	-	398	600	180.0	
10'	254	533	559	406	362	324	30.2	1.6	12-25	335	495	600	240.0	固定球 Fixing Ball
12'	305	610	635	482.6	431.8	381	21.8	1.6	12-25	385	580	800	390.0	
14'	337	686	762	535	476	412.8	35	1.6	12-29	430	625	800	510.0	
16'	387	162	838	597	539.5	469.9	36.6	1.6	16-29	470	720	800	750.0	
20'	489	914	991	698	635	58.2	42.9	1.6	20-32	590	840	800	1190	
24'	591	1067	1143	813	749.5	692.2	47.8	1.6	20-35	700	1050	800	2100	
26'	686	1245	1346	927.1	836.6	800.1	71.4	1.6	28-35	780	1150	800	3000	

主要外形和连接尺寸 Main shape and connection dimension

CLASS 300 A3B(3)41、(3)47、(3)67F/Y(N.PPL).(P.RV)

NPS In	主要外形尺寸和连接尺寸 (mm) Main external and connecting dimensions												WT (Kg)	备注 Remark
	d	L-RF	L-BW	D	D1	D2	b	f	N-φ	H1	H2	D0		
1/2'	13	140	-	95	66.5	35	14.2	1.6	4-16	-	59	130	2.5	浮动球 Float Ball
3/4'	19	152	-	117	82.5	43	15.9	1.6	4-19	-	63	130	3.5	
1'	25	165	-	124	89	51	17.5	1.6	4-19	-	75	160	5.5	
1 1/2'	38	190	190	156	114.5	73	20.7	1.6	4-22	-	95	230	10.5	
2'	51	216	216	165	127	92	22.3	1.6	8-19	-	107	230	14.5	固定球 Fixing Ball 浮动球 Float Ball
2 1/2'	61	241	241	190	149	105	25.4	1.6	8-22	-	142	400	23.5	
3'	76	283	283	210	168	127	28.6	1.6	8-22	-	152	400	30.0	
4'	102	305	305	254	200	157	31.8	1.6	8-22	-	178	700	55.0	
5'	127	381	-	279	235	186	35	1.6	8-22	-	252	1100	81.0	
6'	52	403	457	318	270	216	36.5	1.6	12-22	-	272	1100	118.0	
8'	203	502	521	381	330	270	41.3	1.6	12-25	-	342	1500	200.0	
8'	203	502	521	381	330	270	41.3	1.6	12-25	-	398	600	220.2	
10'	354	568	559	444	387.5	324	17.7	1.6	16-29	335	495	600	365	固定球 Fixing Ball
12'	305	648	635	520.8	451	381	50.8	1.6	16-32	385	580	800	530	
14'	337	762	762	584.2	514.5	412.8	53.8	1.6	20-32	430	625	800	740	
16'	387	838	838	647.8	571.5	469.9	57.2	1.6	20-35	470	720	800	1030	
20'	489	991	991	774.8	685.8	58.2	63.5	1.6	24-35	590	840	800	1540	
24'	591	1146	1143	914.4	812.8	692.2	69.8	1.6	24-41	700	1050	800	2600	
28'	686	1346	1346	1035	939.8	800.1	85.9	1.6	28-44.5	780	1150	800	3900	



主要外形和连接尺寸 Main shape and connection dimension

CLASS 400 Q(3)41、(3)47、(3)67F/Y(N.PPL),(P.RV)

NPS In	主要外形尺寸和连接尺寸 (mm) Main external and connecting dimensions												WT (Kg)	备注 Remark
	d	L-RF	L-BW	D	D1	D2	b	f	N-φ	H1	H2	D0		
1/2'	13	165	165	95	66.5	35	14.3	6.4	4-16	-	59	130	6.5	浮动球 Float Ball
3/4'	19	190	190	117	82.5	43	15.9	6.4	4-19	-	63	160	9	
1'	25	216	216	124	89	51	17.5	6.4	4-19	-	75	160	13	
1 1/2'	38	241	241	156	114.5	73	22.3	6.4	4-22	-	95	230	16.5	
2'	51	292	292	165	127	92	25.4	6.4	8-19	-	107	700	25	固定球 Fixing Ball 浮动球 Float Ball
4'	102	406	406	254	200	157.2	35	6.4	8-25	-	178	700	66	
6'	152	495	495	317.5	270	216	41	6.4	12-25	250	300	600	145	
8'	203	597	597	381	330	269.8	47.8	6.4	12-28.5	294	374	800	250	
10'	254	673	673	445	387.5	324	53.8	6.4	16-32	370	445	800	540	
12'	305	762	762	521	451	381	57	6.4	16-35	420	515	800	780	
14'	337	826	826	584	514.5	413	60.5	6.4	20-35	46	550	800	1000	
16'	387	902	902	648	571.5	470	63.5	6.4	50-38	505	615	800	1300	
20'	489	1054	1054	775	686	584.2	69.8	6.4	24-41	630	810	800	2100	固定球 Fixing Ball
24'	591	1232	1232	915	812.8	692.2	76	6.4	24-48	685	845	800	3400	
28'	686	1397	1397	1035	939.8	800	95.3	6.4	28-51	860	1078	800	5000	

主要外形和连接尺寸 Main shape and connection dimension

CLASS 600 Q(3)41、(3)47、(3)67F/Y(N.PPL),(P.RV)

NPS In	主要外形尺寸和连接尺寸 (mm) Main external and connecting dimensions												WT (Kg)	备注 Remark
	d	L-RF	L-BW	D	D1	D2	b	f	N-φ	H1	H2	D0		
1/2'	13	165	165	95	56.5	35	14.3	6.4	4-16	-	59	160	7.5	浮动球 Float Ball
3/4'	19	190	190	117	82.5	43	15.9	6.4	4-19	-	63	160	10.5	
1'	25	216	216	124	89	51	17.5	6.4	4-19	-	75	230	14.5	
1 1/2'	38	241	241	156	114.5	73	22.3	6.4	4-22	-	95	400	18.5	
2'	51	292	292	165	127	92	25.4	6.4	8-19	-	107	700	25	固定球 Fixing Ball 浮动球 Float Ball
4'	102	432	432	273	216	157.2	38	6.4	8-25	-	178	1100	76	
6'	152	559	559	355.6	282.1	216	47.2	6.4	12-29	250	300	600	127	
8'	203	660	660	419.5	349.2	269.8	55.7	6.4	12-32	294	374	800	350	
10'	254	787	787	508	431.8	324	63.5	6.4	16-35	370	445	800	660	
12'	305	838	838	559	489	381	66.5	6.4	20-35	420	515	800	820	
14'	337	889	889	603.2	527	413	69.8	6.4	20-38	460	550	800	1130	
16'	387	991	991	686	603.2	470	76.2	6.4	20-41	505	615	800	1550	
20'	489	1194	1194	818	724	584.2	89	6.4	24-44.5	630	810	800	2800	固定球 Fixing Ball
24'	591	1397	1397	940	838.2	692.2	101.6	6.4	24-51	825	1010	800	5300	
28'	686	1549	1549	1073	965.2	800	111.3	6.4	28-55	970	1180	800	6500	

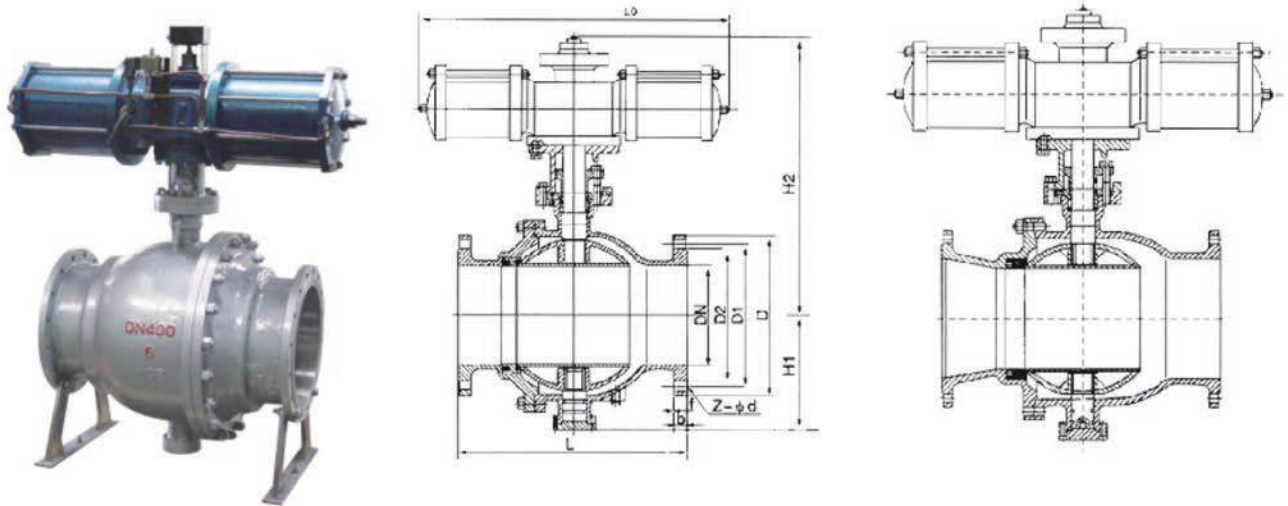

应用规范 Application Specification

- 1、设计、制造按GB/T 12237 Design and produce: GB/T 12237
- 2、结构长度按GB/T 12221 Face to face: GB/T 12221
- 3、连接法兰按JB/T 79.1~79.4、GB/T 9113.1~9113.4 Connection flange: JB/T 79.1-79.4, GB/T 9113.1-9113.4
- 4、阀门检查试验按GB/T 13927 GB/T 9092 Test: GB/T 13927 GB/T 9092

特点 Features

- 1、重量相对较轻  
Light weight
- 2、当介质由进口方向进入的时候，形成一种挤压的冲击力，介质由出口流通的时候，从而实现一种喷吹的效果。  
When the medium enters from the inlet, a squeezing impact force is formed, and when the medium circulates from the outlet, a blowing effect is realized.

主要外形和连接尺寸 Main shape and connection dimension

DN	L	D	D1	D2		b		f		Z-φd	H1	H2	L0	重量(kg) Weight
				系列1 Series 1	系列2 Series 2	系列1 Series 1	系列2 Series 2	系列1 Series 1	系列2 Series 2					
200	500	320	280	254	258	22	26	2	3	8 × Φ17.5	255	730	812	300
250	600	375	335	309	312	24	28	2	3	12 × Φ17.5	310	800	812	370
300	700	440	395	363	365	24	28	2	4	12 × Φ22	370	852	812	440
350	800	490	445	413	415	26	30	2	4	12 × Φ22	440	920	812	770
400	900	540	495	463	465	28	32	2	4	16 × Φ22	490	1050	1020	880
500	1000	645	600	518	570	32	34	2	4	20 × Φ22	610	1100	1020	1100



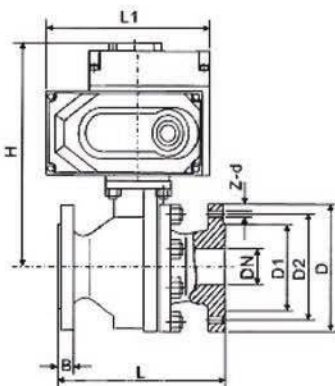

产品概述 Product Overview

电动球阀是一种转角90°的旋转类球阀，密封性能优良，流通能力大，流阻系数小，结构简单、维修方便、使用寿命长，阀体通道和连接管径相等并成一直径，介质几个可以毫无损失的流过。配用GMT、GMTQT等高性能执行机构，产品通常用于密封要求严格的场合，除控制气体、液体、蒸汽介质外，还适宜控制污水和含有纤维性杂质的介质，广泛用于石油、化工、冶金、轻工、造纸、电站、制冷等工作领域。

An electric ball valve is a kind of rotating type ball valve with rotary angle of 90° and features good sealing performance, large flow capacity, small flow resistance coefficient, simple structure, convenient maintenance and long service life. Valve body passage is equal to connecting pipe diameter in size and medium can almost flow through it with no loss. It is used together with a GMT/GMTQT high performance actuator. Such products are usually used on applications with strict sealing requirements. Besides control of gas, liquid and steam medium, they are also suitable for control of sewage and medium containing fibrous impurities. They are widely used in petroleum, chemical industry, metallurgy, light industry, paper making, power plant, refrigeration, and other work fields.

阀门技术参数 Valve Technical Parameters

公称通径 Nominal diameter (mm)	DN15~DN400(mm)
公称压力 Nominal pressure (MPa)	1.0、1.6、2.5、4.0、6.4MPa
适用介质 Applicable medium	水、石油、硝酸类、醋酸类、粘性流体、浆料、强氧化性介质等。 Water, petroleum, nitric acid, acetic acid, viscous fluid, paste, strong oxidizing medium, etc.
介质温度 Medium temperature	-40℃~+180℃ -40℃~+350℃
泄漏量 Leakage	0符合ANSI B16.104 5级标准
球体转角 Rotating angle of ball	90°
阀体材质 Valve body material	A105、F304、F316、WCB、FZG1Cr18Ni9Ti、ZG1Cr18Ni12Mo2Ti、CF8、CF8M、CF3M
阀座材料 Seat material	聚四氟乙烯(常温)、特制PPL(高温)、金属密封(高温) PTFE (room temperature), special PPL (high temperature), metal seal (high temperature)

主要连接尺寸 Main Connection Dimensions

公称通径 Nominal diameter DN(mm)	尺寸 Size (mm)								执行机构选配(常温常压) Optional actuator (atmospheric pressure and normal pressure)	
	L	D	D2	D1	B	H	L1	Z-d		
15	130	95	65	45	14	176	161	4-14	GMT-005	GMTQT-010
20	140	105	75	55	14	180	161	4-14	GMT-005	GMTQT-010
25	150	115	85	65	14	182	161	4-14	GMT-005	GMTQT-010
32	165	135	100	78	16	188	161	4-18	GMT-010	GMTQT-010
40	180	145	110	85	16	198	161	4-18	GMT-010	GMTQT-010
50	200	160	125	100	16	203	161	4-18	GMT-016	GMTQT-010
65	200	180	145	120	18	222	188	4-18	GMT-016	GMTQT-015
80	250	195	160	135	20	237	188	8-18	GMT-020	GMTQT-020
100	280	215	180	155	20	261	268	8-18	GMT-040	GMTQT-030
125	320	245	210	185	22	300	268	8-18	GMT-060	GMTQT-040
150	360	280	240	210	24	300	268	8-23	GMT-100	GMTQT-080
200	400	335	295	265	26	368	268	12-23	GMT-100	GMTQT-120
250	533	405	335	320	30	418	268	12-25	GMT-200	GMTQT-200

注：以上选配参数仅供参考，具体以实际情况为准。

Note: The above optional parameters are only for reference, Specific actual conditions shall prevail.

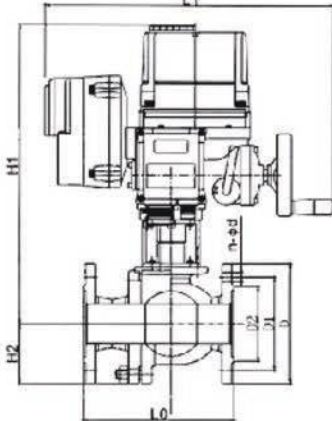

产品简介 Product Overview

防爆电动球阀按其密封性能可分软密封阀座及金属密封阀座。软密封阀座适用于温度≤180℃的场合，金属硬密封阀座适用于温度≤425℃的场合。适用于含有可燃性气体、蒸气与空气形成的易燃、易爆混合物的车间、仓库等场所，除控制气体、液体、蒸汽介质外，还适宜控制污水和含有纤维性杂质的介质，广泛用于石油、化工、冶金、轻工、造纸、电站、制冷等工作领域。

Explosion-proof electric ball valves can be divided into soft sealing seats and metal sealing seats according to their tightness. The soft seat is suitable for the temperature ≤180°, and the metal hard seat is suitable for the temperature ≤425°. It is suitable for workshops, warehouses and other places with flammable and explosive mixtures of flammable gas, steam and air. In addition to controlling gas, liquid, and steam media, it is also suitable for controlling sewage and media containing fibrous impurities. It is widely used in petroleum, chemical industry, metallurgy, light industry, papermaking, power station, refrigeration and other working fields.

技术参数 Technical Parameters

公称通径 Nominal diameter (mm)		20~250		
公称压力 Nominal pressure (MPa)		1.6	2.5	6.4
材料代号		C	P	R
主要零件 Main parts	阀体 Body	WCB	CF8 304	CF8M 316
	密封圈 Sealing	增强聚四氟乙烯 硬密封 Reinforced PTFE Metal sealing		
	填料 Packing	聚四氟乙烯 柔性石墨 PTFE Flexible Graphite		
适用工况 Applicable working conditions	适用介质 Applicable medium	水、油品、空气、天然气、醋酸、硝酸、尿素等介质 Water, oil, air, natural gas, acetic acid, urea and other media		
	适用温度 Applicable temperature	-28℃~150℃ -28℃~350℃		
执行器 Actuator	型号 Model	YCQ型防爆型系列电动执行器 YCQ type explosion-proof series electric actuator		
	动作方式 Action method	智能一体式(开关型/调节型) Intelligent integrated type (switch type/adjustable type)		
	电压 Voltage	AC220V、AC380V、DC24V		
防爆等级 Explosion-proof grade		Exd II CT5		

主要连接尺寸 Main Connection Dimensions

公称通径 DN(MPa)	YCQ			主要连接尺寸 Main Connection Dimension						
	L1	H1	H2	L0	D	D1	D2	C	f	N-Φd
20	270	333	50	140	105	75	56	16	2	4-Φ14
25	270	348	63	150	115	85	65	16	2	4-Φ14
32	270	351	68	165	140	100	76	18	3	4-Φ18
40	270	370	70	180	150	110	84	18	3	4-Φ18
50	270	378	78	200	165	125	99	20	3	4-Φ18
65	346	438	88	220	185	145	118	20	3	4-Φ18
80	358	463	93	250	200	160	132	20	3	8-Φ18
100	358	475	105	280	220	180	156	22	3	8-Φ18
125	358	505	125	320	250	210	184	22	3	8-Φ18
150	390	552	140	360	285	240	211	22	3	8-Φ22
200	390	577	165	400	340	295	266	24	3	12-Φ22
250	390	777	195							



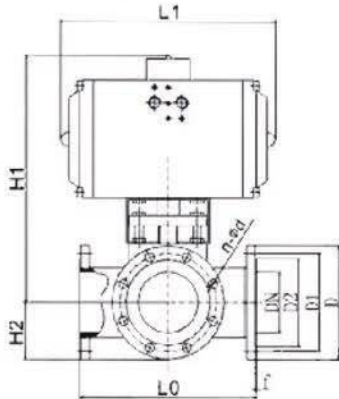

产品简介 Product Overview

气动三通球阀可为L型和T型，L型三通球阀用于介质流向的切换，能使相互垂直的两个通道连接；T型三通球阀用于介质分流、合流及流向切换，T型三通可以使三个通道相互连通或使其中的两个通道连通。一般采用两阀座结构，亦可根据用户要求采用四阀座结构，广泛适用于供水、石化、冶金、矿山、轻纺、能源、造纸、食品、钢铁等管路系统中对介质流向进行切换以及对介质的分流或混合流体。

Pneumatic three-way ball valves can be divided into L-type and T-type. The L-type three-way ball valve is used to switch the flow direction of the medium and can connect two channels that are perpendicular to each other; the T-type three-way ball valve is used to split, merge and switch the flow direction of the medium. T-shaped three-way can make the three channels communicate with each other or make two of them communicate. Generally adopts a two-valve seat structure, and can also adopt a four-valve seat structure according to user requirements. It is widely used in water supply, petrochemical, metallurgy, mining, textile, energy, paper, food, steel and other pipeline systems to switch the flow direction of the medium. Diversion or mixing of media.

技术参数 Technical Parameters

公称通径 Nominal diameter (mm)		20-250		
公称压力 Nominal pressure (MPa)		1.6	2.5	6.4
材料代号 Material		C	P	R
主要零件 Main parts	阀体 Body	WCB	CF8 304	CF8M 316
	阀芯 Disc	WCB	CF8 304	CF8M 316
	阀杆 Stem	2Cr13	0Cr18Ni9Ti	0Cr17NiMo2
	密封圈 Sealing	增强聚四氟乙烯 Reinforced PTFE		
	填料 packing	聚四氟乙烯 柔性石墨 PTFE Flexible Graphite		
适用工况 Applicable working conditions	适用介质 Applicable medium	酸、碱等腐蚀性介质 Acid, alkali and other corrosive media		
	适用温度 Applicable temperature	-28℃~150℃		
执行器 Actuator	型号 Model	AT/GT/AW系列气动执行器 AT/GT/AW series pneumatic actuators		
可选附件 Optional accessories		电磁阀、限位开关、过滤减压阀、定位器、手动机构 Solenoid valve, limit switch, filter pressure reducing valve, positioner, manual mechanism		

安装尺寸 Connection Dimensions

公称通径	GT			AT			主要连接尺寸 Main Connection Dimension							执行器 Actuator
	L1	H1	H2	L1	H1	H2	L0	D	D1	D2	C	f	N-Φd	
20	140	202	50	174	194	50	150	105	75	56	16	2	4-Φ14	AT065/GTD063
25	178	230	63	188	221	63	180	115	85	65	16	2	4-Φ14	AT075/GTD075
32	186	247	68	208	226	68	200	140	100	76	18	3	4-Φ18	AT083/GTD083
40	252	276	70	208	265	70	220	150	110	84	18	3	4-Φ18	AT092/GTD092
50	254	284	78	264	273	78	240	165	125	99	20	3	4-Φ18	AT105/GTD110
65	296	314	88	272	311	88	260	185	145	118	20	3	4-Φ18	AT125/GTD127
80	348	335	93	304	333	93	280	200	160	132	20	3	8-Φ18	AT140/GTD140
100	384	381	105	460	365	105	320	220	180	156	22	3	8-Φ18	AT160/GTD160
125	498	451	125	530	443	125	380	250	210	184	22	3	8-Φ18	AT190/GTD190
150	552	501	140	547	487	140	440	285	240	211	22	3	8-Φ22	AT210/GTD210
200	608	560	165	604	540	165	550	340	295	266	24	3	12-Φ22	AT240/GTD240



主要外形及连接法兰尺寸 Q647F(N、P、H、Y)-20K Main Outline and Connecting Flange Size

公称通径 Nominal diameter		外形尺寸 Outline Size			连接法兰尺寸 Connecting Flange Size						执行器型号 Actuator Model
DN	in	L	L1	~H	D	D1	D2	C	f	n-Φd	
50	2	216	248/345	329/366	155	120	100	18	2	8-Φ19	AT088D/AT125S
65	2 1/2	241	269/409	390/444	175	140	120	20	2	8-Φ19	AT088D/AT145S
80	3	283	345/438	430/472	200	160	135	22	2	8-Φ23	AT125D/AT160S
100	4	305	409/550	494/562	225	185	160	24	2	8-Φ23	AT145D/AT190S
125	5	381	438/600	561/629	270	225	195	26	2	8-Φ25	AT145D/AT190S
150	6	403	550/633	642/702	305	260	230	28	2	12-Φ25	AT170D/AT240S
200	8	502	600/633	700/735	350	305	275	30	2	12-Φ22	AT210D/AT240S
250	10	568	730	775/805	430	380	345	34	2	12-Φ27	AT240D/AT270S
300	12	648	1180	818	480	430	395	35	3	16-Φ27	AW20/AW25S
350	14	762	1180	926	540	480	440	40	3	16-Φ33	AW20/AW28S
400	16	838	1320	983	605	540	495	46	3	16-Φ33	AW28/AW35S
500	20	991	1430	1095	730	660	615	50	3	20-Φ33	AW35/AW40S

※注：球阀结构长度及连接法兰尺寸可根据JB/T79标准或用户要求设计制造。  
※注：执行器型号XXX/XXX分别是气动执行器双作用式/单作用式（弹簧复位）。  
※注：根据不同阀门扭矩、使用介质适配的执行器型号可能有所不同，相关尺寸随之变化。  
※注：以上执行器配置及数据均采用软密封(F、N、P)阀门，硬密封阀门的配置及数据请咨询本公司。  
Note: The structural length and connecting flange size of ball valve series can be designed and manufactured as per JB/T79 standard or users' requirements.  
Note: Data XXX/XXX represent respectively the double-acting/single-acting type (spring reposition) of pneumatic actuator.  
Note: \*The relative sizes are subject to change responding to the difference in valve torque, medium and actuator model.  
Note: the above actuator configuration and data all use soft-sealed valves (F, N, P) and hard-sealed valves, or consulting us if you have more questions.



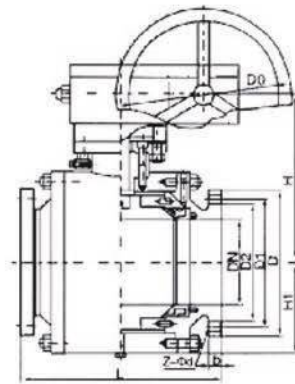
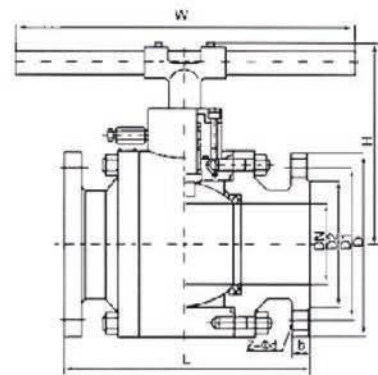

### 应用规范 Application Specification

- 1、设计、制造按GB/T 12238-89 Design,manufacture according to GB/T 12238-89
- 2、结构长度按GB/T 12221-89 F/F standard according to GB/T 12221-89
- 3、连接法兰：JB 9113-88 Flange according to JB 9113-88
- 4、阀门检查和试验按GB/T 13927-92 Testing according to GB/T 13927-92

### 1.6MPa主要外形和连接尺寸 1.6MPa main shape and connection dimension

公称通径 DN	尺寸(mm)								
	L	D	D1	D2	b	Z-φd	H	H1	Do
50	220	160	125	100	16	4-φ18	160	85	-
65	241	180	145	120	18	4-φ18	170	95	-
80	283	195	160	135	20	8-φ18	200	110	-
100	305	215	180	155	20	8-φ8	210	120	-
125	356	245	210	185	22	8-φ18	350	215	-
150	394	280	240	210	24	8-φ23	530	190	-
200	457	335	295	265	26	12-φ23	575	230	230
250	533	405	355	320	30	12-φ25	585	260	600
300	610	460	410	375	30	12-φ25	730	300	600
350	686	520	470	435	34	16-φ25	860	350	800
400	762	580	525	485	36	16-φ30	935	395	800
450	864	640	585	545	40	20-φ30	975	440	800
500	914	705	650	608	44	20-φ34	1060	485	800
600	1067	840	770	718	48	20-φ41	1170	591	800
700	1245	910	840	788	50	24-φ41	1270	686	800

### 2.5MPa主要外形和连接尺寸 2.5MPa main shape and connection dimension

公称通径 DN	尺寸(mm)								
	L	D	D1	D2	b	Z-φd	H	H1	Do
50	220	160	125	100	20	4-φ18	160	85	-
65	241	180	145	120	22	8-φ18	170	95	-
80	283	195	160	135	22	8-φ18	200	110	-
100	305	230	190	160	24	8-φ23	210	120	-
125	381	270	220	188	28	8-φ25	350	215	-
150	403	300	250	218	30	8-φ25	550	190	-
200	502	360	310	278	34	12-φ25	575	230	600
250	568	425	370	332	36	12-φ30	585	260	600
300	648	485	430	390	40	16-φ30	730	300	600
350	762	550	490	448	44	16-φ34	860	350	800
400	838	610	550	505	48	16-φ34	935	395	800
450	864	660	600	555	50	20-φ34	975	440	800
500	991	730	660	610	52	20-φ41	1060	48	800
600	1067	840	770	718	56	20-φ41	1170	591	800
700	1245	955	875	815	60	24-φ48	1270	686	800

### 4.0MPa主要外形和连接尺寸 4.0MPa main shape and connection dimension

公称通径 DN	尺寸(mm)									
	L	D	D1	D2	D6	b	Z-φd	H	H1	Do
50	220	160	125	100	88	20	4-φ18	160	85	-
65	241	180	145	120	110	22	8-φ18	170	95	-
80	283	195	160	135	121	22	8-φ18	200	110	-
100	305	230	190	160	150	24	8-φ23	210	120	-
125	381	270	220	188	176	28	8-φ25	350	215	-
150	403	300	250	218	204	30	8-φ25	530	190	-
200	502	375	320	282	260	38	12-φ30	575	230	600
250	568	445	385	345	313	42	12-φ34	585	260	600
300	648	510	450	408	364	46	16-φ34	730	300	600
350	762	570	510	465	422	52	16-φ34	860	350	800
400	838	655	585	535	474	58	16-φ41	935	395	800
450	914	680	610	560	524	60	20-φ41	975	440	800
500	991	755	670	612	576	62	20-φ48	1060	485	800
600	1143	890	795	730	678	62	20-φ54	1170	591	800
700	1346	995	900	835	768	68	24-φ54	1270	686	800

### 6.4MPa主要外形和连接尺寸 6.4MPa main shape and connection dimension

公称通径 DN	尺寸(mm)									
	L	D	D1	D2	D6	b	Z-φd	H	H1	Do
50	292	175	135	105	88	26	4-φ23	160	85	-
65	330	200	160	130	110	28	8-φ23	170	95	-
80	356	210	170	140	121	30	8-φ23	200	110	-
100	432	250	200	168	150	32	8-φ25	210	120	-
125	508	295	240	202	176	36	8-φ30	350	215	-
150	559	340	280	240	204	38	8-φ34	530	190	600
200	660	405	345	300	260	44	12-φ34	575	230	600
250	787	470	400	352	313	48	12-φ41	585	260	600
300	838	530	460	412	364	54	16-φ41	730	300	800
350	889	595	525	475	422	60	16-φ41	860	350	800
400	991	670	585	525	474	66	16-φ48	935	395	800
450	1092	670	630	570	524	70	20-φ48	975	440	800
500	1194	800	705	640	576	70	20-φ54	1060	485	800
600	1397	930	820	750	678	76	20-φ58	1170	591	800

### 10.0MPa主要外形和连接尺寸 10.0MPa main shape and connection dimension

公称通径 DN	尺寸(mm)									
	L	D	D1	D2	D6	b	Z-φd	H	H1	Do
50	292	185	145	112	88	28	4-φ25	166	90	-
65	330	220	170	138	110	32	8-φ25	175	100	-
80	356	230	180	148	121	34	8-φ25	210	115	-
100	432	265	210	172	150	38	8-φ30	215	125	-
125	508	310	250	210	176	42	8-φ34	360	196	-
150	559	350	290	250	204	46	12-φ34	540	220	600
200	660	430	360	312	260	54	12-φ41	590	235	600
250	787	500	430	382	313	60	12-φ41	600	265	600
300	838	585	500	442	364	70	16-φ48	740	310	800
350	889	655	560	498	422	76	16-φ54	870	370	800
400	991	715	620	558	474	80	16-φ54	950	410	800
450	1194	770	675	615	524	84	20-φ58	990	460	800
500	1397	870	760	690	576	90	20-φ58	1100	495	800
600	1549	990	875	800	678	95	24-φ58	1200	600	800



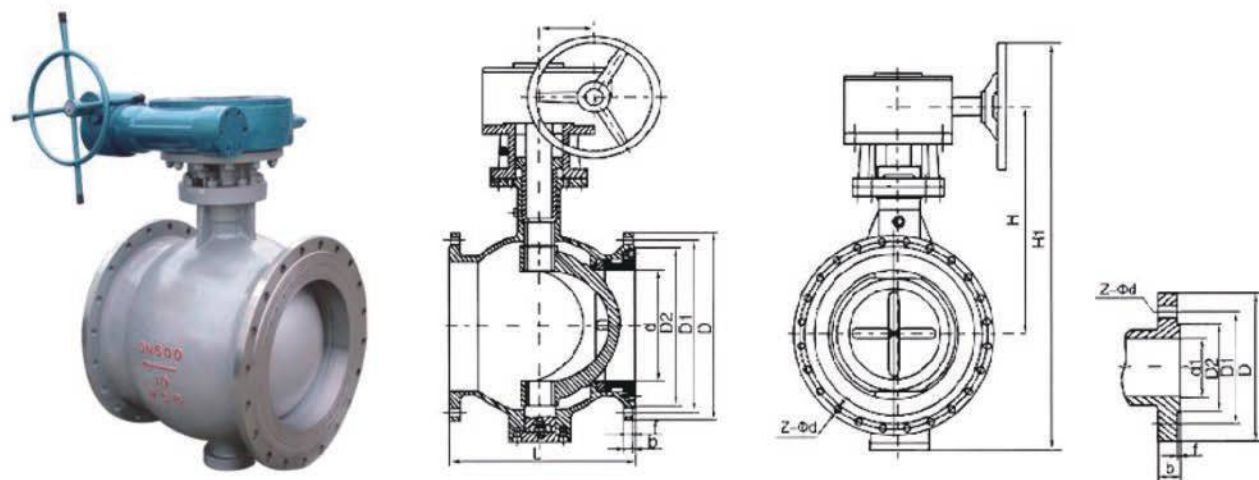

主要外型及连接尺寸表 Main shape and connection dimension

公称压力 PN(MPa)	公称通径 DN		尺寸 (mm)							
	mm	in	L 法兰	D	D1	D2	D6	b	f	Z-φd
PBQ340 <sup>H</sup> <sub>F</sub> -1.0 <sup>C</sup> <sub>R</sub>	40	-	165	145	110	85	-	16	3	4-18
	50	-	178	160	125	100	-	16	3	4-18
	65	-	190	180	145	120	-	18	3	4-18
	80	-	203	195	160	135	-	20	3	4-18
	100	-	229	215	180	155	-	20	3	8-18
	125	-	254	245	210	185	-	22	3	8-18
	150	-	267	280	240	210	-	24	3	8-23
	200	-	292	335	295	265	-	24	3	8-23
	250	-	330	390	350	320	-	26	3	12-23
	300	-	356	440	400	368	-	26	4	12-23
	350	-	381	500	460	428	-	28	4	16-23
	400	-	430	565	515	482	-	28	4	16-25
	450	-	502	615	565	532	-	30	4	20-25
	500	-	550	670	620	585	-	30	4	20-25
	600	-	660	780	725	685	-	34	5	20-30
	700	-	770	895	840	800	-	38	5	24-30
PBQ340 <sup>H</sup> <sub>F</sub> -1.6 <sup>C</sup> <sub>R</sub>	800	-	880	1010	950	905	-	42	5	24-34
	900	-	1000	1115	1050	1005	-	38	5	28-33
	1000	-	1100	1230	1160	1080	-	38	5	28-36
	1200	-	1300	1455	1380	1292	-	44	5	28-39
	40	-	165	145	110	85	-	16	3	4-18
	50	-	178	160	125	100	-	16	3	4-18
	65	-	190	180	145	120	-	18	3	4-18
	80	-	203	195	160	135	-	20	3	8-18
	100	-	229	215	180	155	-	20	3	8-18
	125	-	254	245	210	185	-	22	3	8-18
	150	-	267	280	240	210	-	24	3	8-23
	200	-	292	335	295	265	-	26	3	12-23
	250	-	330	405	355	320	-	30	3	12-25
	300	-	356	460	410	375	-	30	4	12-25
	350	-	381	520	470	435	-	34	4	16-25
	400	-	430	580	525	485	-	36	4	16-30
	450	-	502	640	585	545	-	40	4	20-30
	500	-	550	705	650	608	-	44	4	20-34
	600	-	660	840	770	718	-	48	5	20-41
	700	-	770	910	840	788	-	50	5	24-41
	800	-	880	1020	950	898	-	52	5	24-41
	900	-	1000	1125	1050	998	-	44	5	28-39
	1000	-	1100	1255	1170	1110	-	46	5	28-42
	1200	-	1300	1485	1390	1325	-	52	5	32-48



气动V型球阀 Pneumatic V Type Ball Valve

型 号: VQ670H(P, Y)  
口 径: DN25~500mm  
压 力: 1.6、2.5、4.0、6.4MPa; 150Lb、300Lb、600Lb;  
结 构: V型切口固定球  
尺寸标准: 国标、美标、日标  
门体材质: 碳钢(WCB)、不锈钢(CF8、CF8M、CF3、CF3M)  
阀座材料: 硬质合金(H、Y)  
作用方式: 双作用、单作用(弹簧复位)  
控制方式: 开关型、调节型  
附件选择: 电磁阀、定位器、限位开关  
气源处理三件、手动机构

Pneumatic V-Ball Valve  
Model: VQ670H(P, Y)  
Bore: DN25~500MM  
Pressure: 1.6, 2.5, 4.0, 6.4MPa;  
150Lb, 300Lb, 600Lb;  
Structure: Fixed V-notch ball  
Dimension standard: GB, API, JIS  
Body material: Carbon steel (WCB)  
Stainless steel (CF8, CF8M, CF3, CF3M)  
Seat material: H, Y  
Mode of action: the double-acting/single-acting  
type(spring reposition) of pneumatic actuator  
Control: Switch type, Adjust type  
Selection of Accessories: solenoid valve, Locator,  
Limit switch, F.R.L. COMBINATION UNIT, Manual Device.



主要外形及连接法兰尺寸 VQ670H(P、Y)-PN16、25 Main shape and connection flange dimension

公称通径 Nominal diameter DN	外形/连接尺寸Outline/Connecting Size						执行器型号 Actuator Model
	L	L <sub>1</sub>	~H	H <sub>1</sub>	D	D <sub>1</sub>	
25	62	159/248	260/290	87	68	38	AT063D/AT088S
32	62	159/248	267/297	87	78	42	AT063D/AT088S
40	62	211/248	292/312	87	85	50	AT075D/AT088S
50	75	248/269	292/312	97	100	60	AT088D/AT100S
65	90	248/315	332/340	112	120	75	AT088D/AT115S
80	100	269/345	350/381	112	130	94	AT100D/AT125S
100	115	345/409	394/411	122	158	110	AT125D/AT145S
125	129	409/438	410/416	142	180	135	AT145D/AT160S
150	160	438/550	461/486	165	216	165	AT160D/AT190S
200	200	550/600	509/553	195	268	210	AT190D/AT210S
250	240	633/730	572/628	237	325	260	AT240D/AT270S

主要外形及连接法兰尺寸 VQ670H(P、Y)-Class150 Main shape and connection flange dimension

公称通径 Nominal diameter DN	外形/连接尺寸Outline/Connecting Size						执行器型号 Actuator Model
	L	L <sub>1</sub>	~H	H <sub>1</sub>	D	D <sub>1</sub>	
25	1	62	159/248	260/290	87	68	AT063D/AT088S
32	1 1/4	62	159/248	267/297	87	78	AT063D/AT088S
40	1 1/2	62	211/248	292/312	87	85	AT075D/AT088S
50	2	75	248/269	292/312	97	100	AT088D/AT100S
65	2 1/2	90	248/315	332/340	112	120	AT088D/AT115S
80	3	100	269/345	359/381	112	130	AT100D/AT125S
100	4	115	345/409	394/411	122	158	AT125D/AT145S
125	5	129	409/438	410/416	142	180	AT145D/AT160S
150	6	160	438/550	461/486	165	216	AT160D/AT190S
200	8	200	550/600	509/553	195	268	AT190D/AT210S
250	10	240	633/730	572/628	237	325	AT240D/AT270S

※注：球阀结构长度及连接法兰尺寸可根据JB/T79标准或用户要求设计制造。  
※注：执行器型号XXX/XXX分别是气动执行器双作用式/单作用式（弹簧复位）。  
※注：根据不同阀门扭矩、使用介质适配的执行器型号可能有所不同，相关尺寸随之变化。  
※注：以上执行器配置及数据均采用软密封(F、N、P)阀门，硬密封阀门的配置及数据请咨询本公司。  
Note: The structural length and connecting flange size of ball valve series can be designed and manufactured as per JB/T79 standard or users' requirements.  
Note: Data XXX/XXX represent respectively the double-acting/single-acting type(spring reposition) of pneumatic actuator.  
Note: \*The relative sizes are subject to change responding to the difference in valve torque, medium and actuator model.  
Note: the above actuator configuration and data all use soft-sealed valves (F, N, P) and hard-sealed valves, or consulting us if you have more questions.

技术规范 Technical specification

设计依据 Design Basis	GB标准 Standard	ANSI标准 Standard
设计标准 Design Standard	GB/12237	ANSI B16.34
连接法兰尺寸 Connecting Flange Size	GB/9113、JB/T79	ANSI B16.5
试验和检验 Test & inspection	JB/T9092	API 598

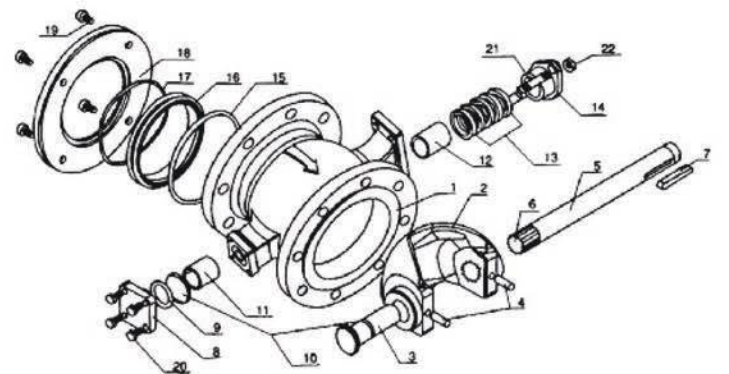

零件清单 Parts List

序号No.	名称	Name	数量(件) Quantity(pieces)	材料 Material
1	阀体	Body	1	WCB、CF8、CF8M、CF3、CF3M
2	阀芯	Spool	1	CF8、CF8M+镀硬铬或超音速喷涂
3	后阀杆	After steam	1	17-4PH、SS316
4	圆柱销	Cylindrical pin	2	SS304、SS316
5	前阀杆	Before steam	1	17-4PH、SS316
6	花键	Spline	1	17-4PH、SS316
7	平键	Flat key	1	SS304、45#
8	后压盖	After gland	1	CF8、CF8M
9	O形圈	"O"-Ring	1	氟橡胶 Viton
10	调整垫	Adjust pad	各1	PTFE
11	自润滑轴承	Self-lubricating bearings	1	复合材料 Composite material
12	自润滑轴承	Self-lubricating bearings	1	复合材料 Composite material
13	填料	Packing	1组	PTFE
14	填料压盖	Gland	1	CF8
15	O形圈	"O"-Ring	1	氟橡胶 Viton
16	密封座	Seal block	1	SS304、SS316+镀硬铬或超音速喷涂
17	密封座弹簧	Seal block spring	1	SS316
18	密封座盖	Sealing lid	1	Q235、SS304、SS316
19	内六角螺钉	Inner Hexagon screw		SS304
20	六角螺钉	Hexagon screw	4	SS304
21	双头螺钉	Double-headed screw	2	SS304
22	六角螺母	Hexagon nut	2	SS304



全焊接钢制球阀材料图表  
FULLY-WELD STEEL BALL VALVE MATERIAL CHART

公称通径: DN15-DN1500  
压力等级: PN16-PN420  
适用温度: -29℃-200℃  
使用介质: 水、气、油  
操作方式: 手柄、齿轮、电动、气动  
使用领域: 集中供热管线、城市供暖管线、  
换热机组、发电厂、造船、  
冶金、石油等工业管线。

Nominal diameter: DN15-DN1500  
Pressure rating: PN16-PN420  
Suitable temperature: -29℃-200℃  
The use of medium: water, oil, gas  
Mode of operation: the handle, gear, electric, pneumatic  
Application field: the central heating pipeline, city heating pipeline,  
Heat exchanger unit, power plant, metallurgy, shipbuilding,  
oil and other industrial pipeline.

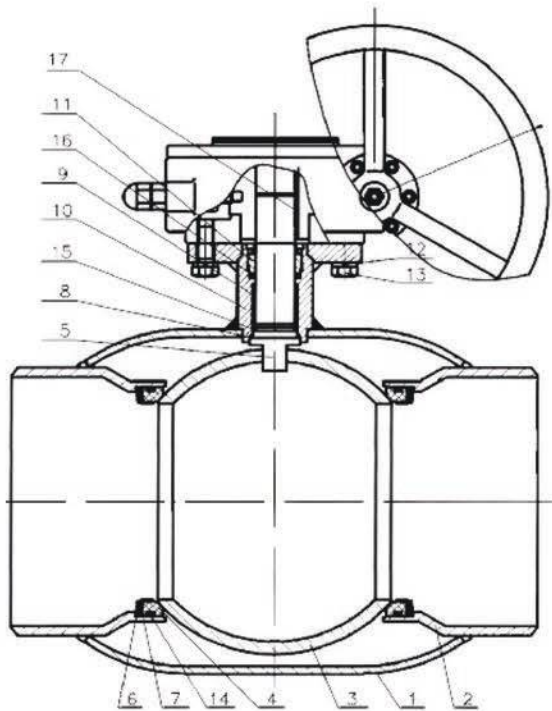

焊接球阀材料说明 Welded ball valve Material Description

序号	名称	材料	Article	Material
1	阀体	碳钢ST37.0	Ball	Steel ST37.0
2	接管	碳钢ST37.0	Gas fitting	Steel ST37.0
3	球体	不锈钢SS304	Ball	Stainless steel SS304
4	阀座	PPL	Body seat	PPL
5	阀杆	不锈钢2Cr13	Stem	Stainless steel 2Cr13
6	碟簧	65 Mn	Disc spring	65 Mn
7	金属垫	不锈钢SS304	Metal pad	Stainless steel SS304
8	止推轴承	PPL	Thrust bearing	PPL
9	滑动轴承	A36+PTFE	Sliding bearing	A36+PTFE
10	阀杆接头	20#	stem adaptor	20#
11	填料压盖	20#	Packing gland	20#
12	标准型弹簧垫圈	20#镀锌	Standard type spring washer	20# galvanization
13	六角头螺栓	20#镀锌	The six hexagon head bolts	20# galvanization
14	O型圈	VITON	O-ring	VITON
15	O型圈	VITON	O-ring	VITON
16	O型圈	VITON	O-ring	VITON
17	普通平键	45#	Common flat key	45#

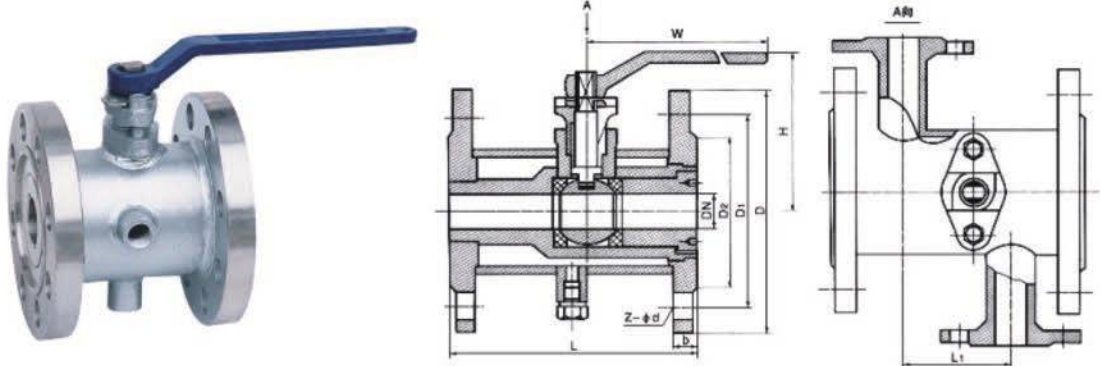

主要外形和连接尺寸 Main shape and connection dimension

单位Unit:mm

公称通径 Nominal diameter DN (mm)	PN1.0MPa									WT(Kg)
	L	L1	D	D1	D2	b	Z-φd	H	W	
15	108	45	95	65	45	14	4-φ14	95	160	2.5
20	117	55	105	75	55	14	4-φ14	101	160	3
25	127	65	115	85	65	14	4-φ14	106	160	5
32	140	78	135	100	78	16	4-φ18	112	230	6
40	165	85	145	110	85	16	4-φ18	125	230	7
50	178	100	160	125	100	16	4-φ18	135	230	10
65	191	120	180	145	125	18	4-φ18	170	400	16
80	203	135	195	160	135	20	8-φ18	193	400	19
100	229	155	215	180	155	20	8-φ18	265	700	33
125	356	185	245	210	185	22	8-φ18	310	700	48
150	394	210	280	240	210	24	8-φ23	355	1100	62
200	457	265	335	295	265	26	12-φ23	410	1500	93
250	533	320	405	355	320	30	12-φ25	560	1500	120

主要外形和连接尺寸 Main shape and connection dimension

单位Unit:mm

公称通径 Nominal diameter DN (mm)	PN1.6MPa									WT(Kg)
	L	L1	D	D1	D2	b	Z-φd	H	W	
15	140	45	95	65	45	16	4-φ14	95	160	3
20	152	55	105	75	55	16	4-φ14	101	160	4
25	165	65	115	85	65	16	4-φ14	106	160	6
32	178	78	135	100	78	18	4-φ18	112	230	7
40	190	85	145	110	85	18	4-φ18	125	230	38
50	216	100	160	125	100	20	4-φ18	135	230	11
65	241	120	180	145	120	22	8-φ18	170	400	18
80	283	135	195	160	135	22	8-φ18	193	400	23
100	305	155	230	190	160	24	8-φ23	265	700	40
125	381	185	270	220	188	28	8-φ25	310	700	70
150	403	210	300	250	218	30	8-φ25	355	1100	102
200	502	265	360	310	278	34	12-φ25	410	1500	150
250	568	320	425	370	332	36	12-φ30	560	1500	182



缩径排气直埋式 (长体型)  
REDUCING VENTING UNDERGROUND TYPE (LONG-BODY)



主要连接尺寸 Main connection size 单位: mm

SIZE	型号	D1		D2	A	L
		EN	GOST			
DN50	2R0502H2T	60.3	57.0	89	300	1000
DN65	2R0652H2T	76.1	76.3	114	300	1000
DN80	2R0802H2T	88.9	89.1	140	300	1000
DN100	2R1002H2T	114.3	108.0	165	300	1000
DN125	2R1252H2T	139.7	133.0	180	400	1000
DN150	2R1502H2T	168.3	159.0	219	400	1000
DN200	2R2002H2T	219.1	219.1	267	400	1000
DN250	2R2502H2T	273.1	273.1	355	500	1000
DN300	2R3002H2T	323.9	323.9	457	500	1100
DN350	2R3502H2T	355.6	377.0	508	500	-
DN400	2R4002H2T	406.4	426.0	558	500	1360
DN450	2R4502H2T	457.0	478.0	558	500	-
DN500	2R5002H2T	508.0	530.0	660	600	1800
DN600	2R6002H2T	609.6	630.0	813	650	1900
DN700	2R7002H2T	712.2	720.0	1016	700	2100
DN800	2R8002H2T	812.8	820.0	1095	800	2350
DN900	2R9002H2T	914.4	920.0	1245	800	2610

缩径直埋式 (短体型)  
SHRINKAGE DIRECTLY BURIED(SHORT FORM)

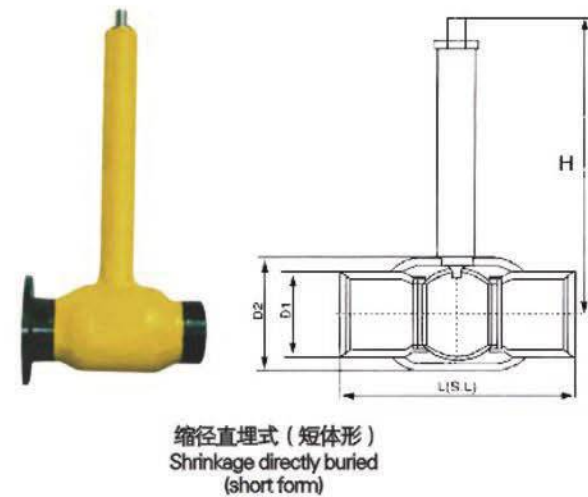

主要连接尺寸 Main connection size 单位: mm

SIZE	型号	D1		D2	L	
		EN	GOST		S	L
DN50	1R0502H0V	60.3	57.0	89	300	1000
DN65	1R0652H0V	76.1	76.3	114	300	1000
DN80	1R0802H0V	88.9	89.1	140	300	1000
DN100	1R1002H0V	114.3	108.0	165	325	1000
DN125	1R1252H0V	141.3	133.0	180	325	1000
DN150	1R1502H0V	168.3	159.0	219	350	1000
DN200	1R2002H0V	219.1	219.1	267	400	1000
DN250	1R2502H0V	273.1	273.1	355	560	1000
DN300	1R3002H0V	323.9	323.9	457	635	1100
DN400	1R4002H0V	406.4	426.0	558	760	1360
DN500	1R5002H0V	508.0	530.0	660	910	1700
DN600	1R6002H0V	610.0	630.0	812	1065	1900
DN700	1R7002H0V	711.0	720.0	1016	1346	2100
DN800	1R8002H0V	813.0	820.0	1130	1524	2350
DN900	1R9002H0V	914.0	920.0	1245	1727	2610

通径直埋式焊接球阀 (短体型)  
FULL BORE UNDERGROUND TYPE WELDING BALL VALVE(SHORT-BODY)

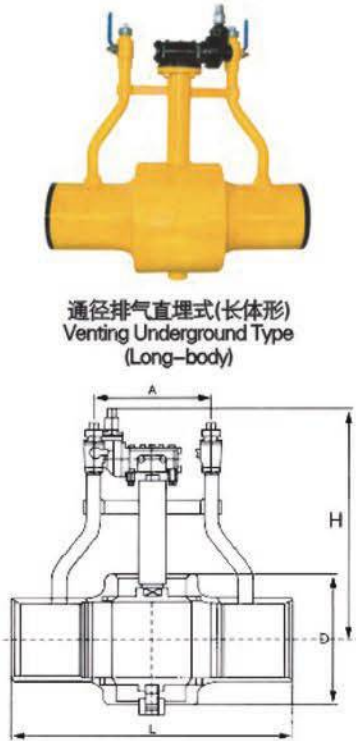

主要连接尺寸 Main connection size 单位: mm

SIZE	型号	D	A	L
DN50	2F0502H2T	114	300	1000
DN65	2F0652H2T	140	300	1000
DN80	2F0802H2T	165	300	1000
DN100	2F1002H2T	216	300	1000
DN150(T)	2F1502H2T	267	400	1000
DN150(V)	2F1502H2V	300	400	1000
DN200	2F2002H2V	356	400	1100
DN250	2F2502H2V	457	500	1100
DN300	2F3002H2V	508	500	1230
DN400	2F4002H2V	660	500	1550
DN500	2F5002H2V	812	600	1700
DN600	2FR6002H2V	1016	700	2000
DN700	2F7002H2V	1130	700	2195
DN800	2F8002H2V	1245	800	2300
DN900	2F9002H2V	1415	900	2550

通径直埋式焊接球阀 (短体型)  
FULL BORE UNDERGROUND TYPE WELDING BALL VALVE(SHORT-BODY)

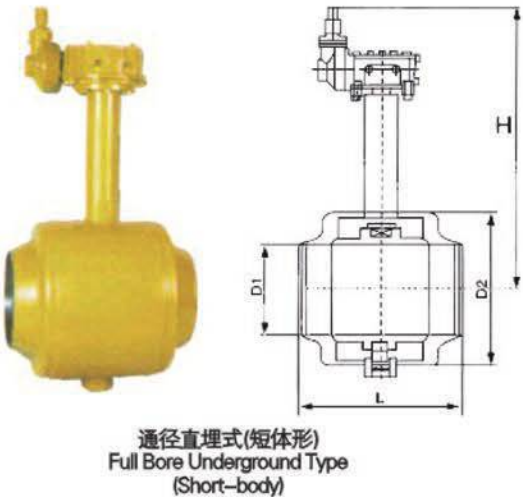

主要连接尺寸 Main connection size 单位: mm

SIZE	型号	D1		D2	L
		EN	GOST		
DN50	1F0502H0T	60.3	57.0	114	300
DN65	1F0652H0T	76.1	76.3	140	300
DN80	1F0802H0T	88.9	89.0	165	300
DN100	1F1002H0T	114.3	108.0	216	325
DN125	1F1252H0T	139.7	133.0	219	350
DN150	1F1502H0T	168.3	159.0	267	490
DN200	1F2002H0V	219.1	219.1	356	580
DN250	1F2502H0V	273.1	273.1	457	550
DN300	1F3002H0V	323.9	325.0	508	630
DN350	1F3502H0V	355.6	377.0	559	762
DN400	1F4002H0V	406.4	426.0	660	838
DN500	1F5002H0V	508.0	530.0	812	970
DN600	1F6002H0V	630.0	630.0	1016	1140
DN700	1F7002H0V	711.0	720.0	1130	1346
DN800	1F8002H0V	813.0	820.0	1245	1524
DN900	1F9002H0V	914.0	920.0	1415	1727



产品概述与用途 Product overview and Application

双向流硬密封球阀是本公司新推出球阀系列的一种产品，该阀不但能在正向压力下可靠地截断，在反向压力或反向压力远大于正向压力时同样能可靠地密封。该阀密封采用半球阀的结构和原理，外形采用蝶式结构，从而具有：体积小、重量轻的特征；并具有：双向硬密封、密封摩擦小、经久耐用、启闭轻便等性能，因此，性价比远高于半球阀。

The two-way flow of hard seal ball valve is the company to launch a new series of products ball valve, the valve can not only reliably truncated at positive pressure, far greater than the positive pressure in the back pressure or back pressure also can be reliably sealed. The structure and principle of the valve sealing hemisphere valve, the butterfly shape structure, which has the characteristics of small size, light weight; and having: bidirectional hard seal, friction is small, durable, opening and closing light performance, sealing it, much higher cost than the hemisphere valve.

主要用途 Main uses

凡水泵出口端、管网系统、回收水系统、高位水槽，易水淹的污水系统，防倒流系统的所有阀门须用双向流阀门，本阀门广泛用于冶金、矿山、石化、化工、电力、环保、市政等行业和部分的管路启闭、调节。

Where the outlet of a water pump, pipeline system, water recycling system, high water tank, water flooding sewage system, all valve back flow prevention system must use the two-way flow valve, the valve is widely used in metallurgy, mining, stone chemical, chemical, electric power, environmental protection, municipal and other industry and part of the pipe opening and closing, regulation.

技术性能规范 Technical performance specifications

公称通径 Nominal diameter (mm)	公称压力 Nominal pressure (MPa)	试验压力 Test pressure(MPa)			适用温度 Suitable temperature (°C)	适用介质 Applicable medium
		壳体强度试验 Shell strength test	正向密封试验 Positive sealing test	反向密封试验 Reverse seal test		
DN50~3000mm	0.6	0.9	0.66	0.66	未注明为0~80℃ 可生产0~200℃ Not specified for the 0~80℃ Can produce 0~200℃	清水 污水 油品等 Clean water Sewage Oil etc.
	1.0	1.5	1.1	1.1		
	1.6	2.4	1.76	1.76		
	2.5	3.75	2.75	2.75		
	4.0	6.0	4.4	4.4		

主要零件材料 Materials of main parts

零部件名称 Parts name	材料名称或代号 Material name
阀体 Body	灰铸铁、球墨铸铁、WCB、碳钢、不锈钢 Grey cast iron, ductile iron, carbon steel, stainless steel, WCB
阀板 Plate	WCB、Q235、不锈钢 Stainless steel
阀杆 Stem	不锈钢 Stainless steel
阀座 Seat	WCB、Q235、不锈钢 Stainless steel

主要类型及工作原理 The main types and working principle

1、主要类型：

本阀门的主要类型有手动、蜗轮蜗杆、电动、气动、液动、其中气动阀门和液动阀门适合与有压力气源和压力液源の場合。

1. Main type

The main types of the valves are manual, worm gear, electric, pneumatic, hydraulic, pneumatic valves and hydraulic valve for pressure source and pressure of fluid source.

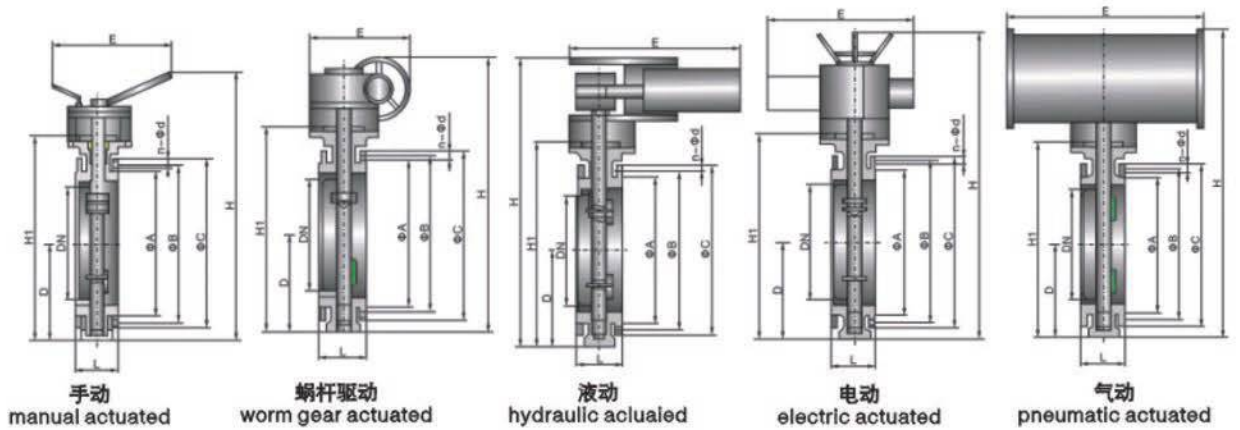

1.6MPa 主要连接尺寸 Main connection dimensions

GWXDF3207Y-6C对夹式 Wafer type、GWXDF9204Y-6C法兰式 Flange type

公称通径 DN(mm)	A	B	C	D	E			H			L		N-ΦD	
					手动 manual actuated	气动 pneumatic actuated	电动 electric actuated	手动 manual actuated	气动 pneumatic actuated	电动 electric actuated	对夹式 wafer type	法兰式 flange form	对夹式 wafer type	法兰式 flange form
50	99	125	165	112	200	245	255	350	625	530	43	108	4-18	4-18
65	118	145	185	115	200	245	255	370	625	530	46	112	4-18	4-18
80	132	160	200	120	200	245	255	380	645	565	65	114	4-18	8-18
100	156	180	220	138	200	355	255	420	675	600	64	127	4-18	8-18
125	184	210	250	165	200	355	255	460	715	640	70	140	4-18	8-18
150	211	240	285	175	280	355	315	555	800	705	76	140	4-22	8-22
200	266	295	340	200	425	450	315	760	850	775	89	152	4-22	12-22
250	319	355	405	230	425	450	315	830	925	945	114	165	4-26	12-26
300	370	410	460	260	460	450	315	895	1035	1070	114	178	4-26	12-26
350	429	470	520	300	460	450	315	950	1070	1140	127	190	4-26	16-26
400	480	525	580	340	580	450	315	1190	1190	1210	140	216	4-30	16-30
450	548	585	640	350	580	650	714	1255	1250	1335	152	222	4-30	20-30
500	609	650	715	380	580	650	714	1305	1290	1415	152	229	4-M30	20-33
600	720	770	840	450	660	850	810	1340	1455	1605	178	267	4-M33	20-36
700	794	840	910	480	750	850	810	1520	1585	1844	229	292	4-M33	24-36
800	901	950	1025	530	750	1250	810	1710	1700	2040	241	318	4-M36	24-39
900	1001	1050	1125	580	750	1250	863	1810	1965	2255	241	330	4-M36	28-39
1000	1112	1170	1255	650	750	1250	863	1960	2015	2380	300	410	4-M39	28-42
1200	1328	1390	1485	760	925	1250	863	2250	2250	2640	350	470	4-M45	32-48
1400	1530	1590	1685	850	925	1250	1055	2434	2250	2866	390	530	4-M45	36-48
1600	1750	1820	1930	1030	925	1250	1055	2780	2750	3156	420	600	4-M52	40-55
1800	1950	2020	2130	1230	980	1250	1183	3020	2950	3421	480	670	4-M52	44-55
2000	2150	2230	2345	1350	980	1500	1286	3270	3350	3685	540	760	4-M56	48-60

注：分母值为PN2.5的尺寸。 Notice: the denominator is PN2.5.